

## **Additional Contact Information**



### **Phone Numbers**

Oakland Park Solid Waste Office 954-630-4452  
Oakland Park Billing and Utility Services Office 954-630-4280  
ARC Broward Electronics – Ft. Lauderdale 954-577-4160  
– Sunrise 954-746-9400  
Broward Sheriff's Office 954-561-6161  
(for vandalized or stolen solid waste containers)

### **Websites**

Oakland Park [www.oaklandparkfl.gov](http://www.oaklandparkfl.gov)

### **Locations**

Oakland Park Solid Waste Office 3801 NE 5th Avenue  
Drop-off site for recycle items and used tires Oakland Park  
Oakland Park Billing and Utility Services Office 3650 NE 12th Avenue  
Account issues Oakland Park

### **BULK & YARDWASTE DROP-OFF SITE**

**SUN 7** at 1815 S. Powerline Road  
Saturdays from 8 am to 4 pm Deerfield Beach  
**SUN 12** at 2380 College Avenue  
Davie

### **ELECTRONIC WASTE DROP-OFF SITE**

ARC BROWARD  
3300 SW 13th Avenue  
Ft. Lauderdale  
Monday-Friday 8:30 am to 4:00 pm  
Monday-Friday 8:00 am to 4:00 pm 10250 NW 53 Street  
Sunrise

### **TIRE DROP OFF SITE**

**SUN 7** at 1815 S. Powerline Road  
Saturdays from 8:00 am to 4:00 pm Deerfield Beach  
Public Works Yards - Mon-Fri - 8 am to 4:30 pm 3801 NE 5th Avenue  
Oakland Park

**STARTING ON JANUARY 4, 2014** **SUN 2** 2281 NW 16th Street  
HOUSEHOLD HAZARDOUS WASTE (HHW) Pompano Beach  
AND ELECTRONIC WASTE DROP-OFF SITE



## **2013/2014**

## **“Talkin’ Trash” Guidelines**

Includes information for Solid Waste, Bulk Trash, and Single Stream Recyclables Collection & New drop-off locations.







**Solid Waste Services**  
**Your Solid Waste and Recycling Program**  
**Working For You!**

Public Works Department  
Solid Waste Division  
3801 NE 5 Avenue  
954-630-4452

Dear Resident:

It is our pleasure to serve you and bring you the newly updated Solid Waste Services "Talkin' Trash" Guide.

The "Talkin' Trash" Guide has been designed to provide you with information regarding your City of Oakland Park solid waste services. This guide will enable you to:

-  Properly prepare your garbage, bulk waste and recycling for curbside and dumpster collection;
-  Be informed of the newly revised rules pertaining to residential bulk trash collection;
-  Know which items are acceptable and which items are unacceptable for collection;
-  Locate your collection service dates by using the location maps;
-  Find locations for disposal of bulk trash, unwanted household hazardous waste and old electronics.

If you have any questions, please call us at 954-630-4452 or visit our website at [www.oaklandparkfl.gov](http://www.oaklandparkfl.gov).

City of Oakland Park Commission

John Adornato III, Mayor

Shari L. McCartney, Vice Mayor

Jed Shank, Commissioner

Tim Lonergan, Commissioner

Sara Guevrekian, Commissioner

[www.oaklandparkfl.gov](http://www.oaklandparkfl.gov)

### Carts and Refuse Service Area Map

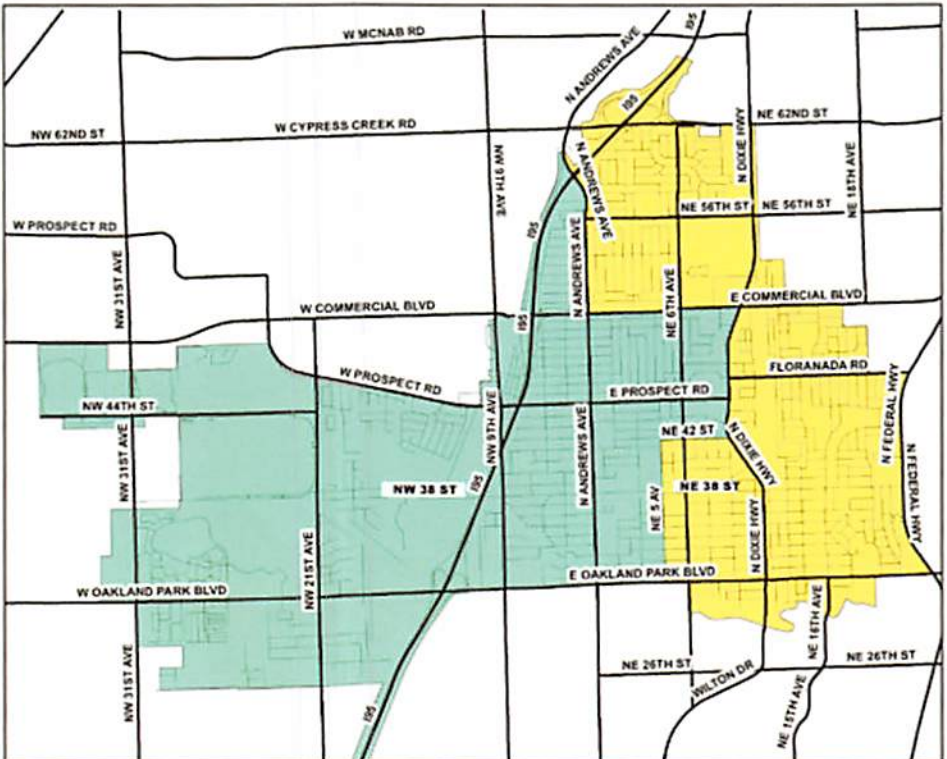

**New Refuse Collection Schedule**  
**Collection Days**  
 Monday/Thursday  
 Tuesday/Friday

City of Oakland Park - Refuse Collection Days

[www.oaklandparkfl.gov](http://www.oaklandparkfl.gov)



# Table of Contents



- RESIDENTIAL BULK TRASH GUIDELINES . . . . . 1,2
- GARBAGE COLLECTION GUIDELINES . . . . . 3,4
- CART AND CONTAINER MAINTENANCE . . . . . 5
- RECYCLING SERVICES (Single Stream) . . . . . 6
- DROP-OFF SITES FOR BULK TRASH/YARD WASTE . . . . . 7
- HOUSEHOLD HAZARDOUS WASTE . . . . . 8
- ELECTRONIC (E-WASTE) RECYCLING . . . . . 9
- PICKUP SCHEDULES AND MAPS . . . . . 10,11,12
- ADDITIONAL CONTACT INFORMATION . . . . . 13



**Solid Waste Office: 954-630-4452**  
 Utility and Billing Services: 954-630-4280



[www.oaklandparkfl.gov](http://www.oaklandparkfl.gov)

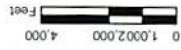

City of Oakland Park- Bulk Trash Weekly Schedules Effective November 5, 2012

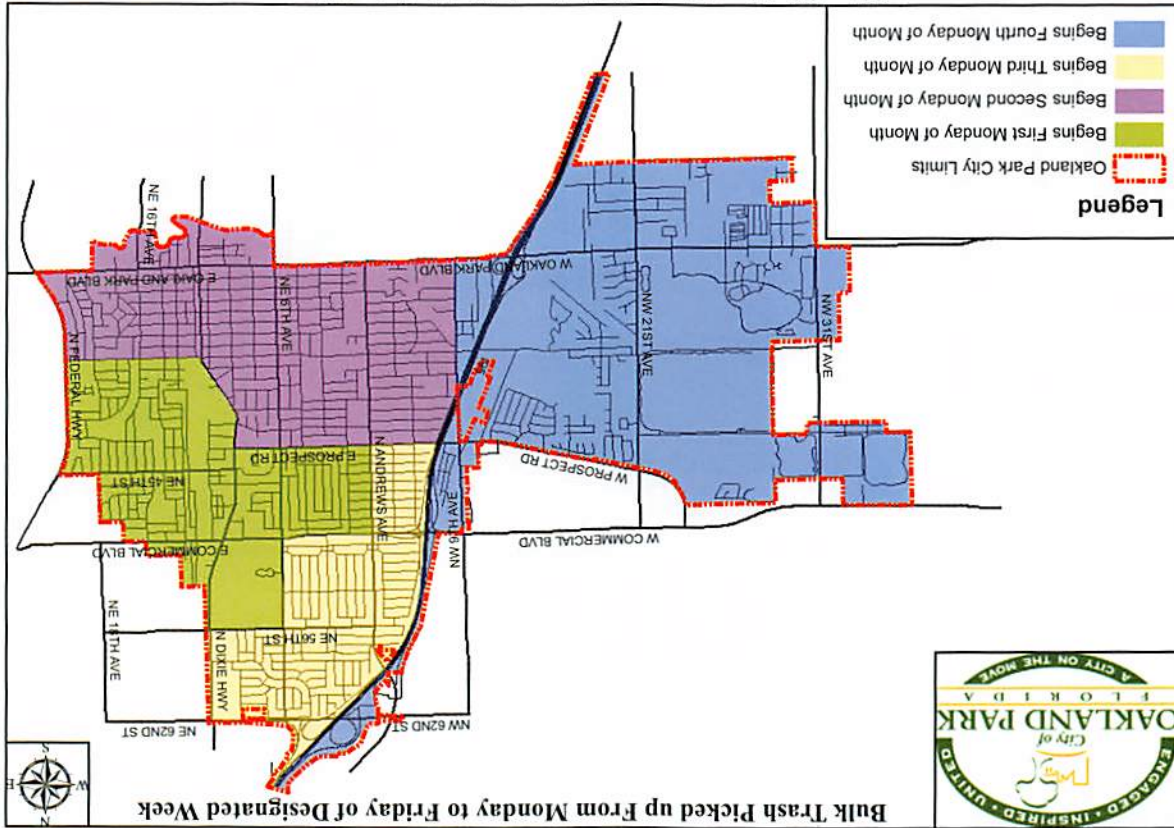

Bulk Trash Picked up From Monday to Friday of Designated Week



954-630-4452



## Residential Bulk Trash Collection

Single family residences, duplexes and triplexes are provided monthly bulk trash disposal of household items listed below. Bulk trash items must be placed at curbside by 7:00 a.m. on the first Monday of the collection week and may be placed out up to 48 hours ahead of the Monday. (See Page 11 for scheduled collection weeks for each area.) Scheduled collection days are in effect for all holidays except Christmas. A collection day scheduled on Christmas will be delayed until the next work day. Due to the volume of bulk waste which may be set out, actual collection for some properties may occur up to four days after the scheduled Monday date. Residents with unacceptable bulk items will be notified by Code Enforcement and given three days to remove items. Call the **Solid Waste Office at 954-630-4452** for further information.

### Bulk Trash Curbside Collection Rules

- It is no longer necessary to bundle yard waste (tree trimmings/branches). **Separate all bulk yard waste from other bulk items.** Tree limbs may be up to eight feet in length.
- Carpeting, rugs and padding cannot exceed 50 pounds in weight.
- Glass must be wrapped in newspaper and placed in secure weatherproof containers.
- White goods (appliances) and metal items must be **put out separately. Doors must be removed from appliances, and valves must be removed from propane tanks.**
- Bulk trash must be generated by the customer at the residential location where the bulk trash is collected.
- Bulk trash items must be at least four feet from any other non-bulk items (fences, solid waste receptacles, poles, hydrants, cars, etc.) and not under low hanging tree branches or wires.



### Bulk Trash Items Accepted For Pickup

- Carpeting, Rugs and Padding
- Glass
- Household Furniture
- Tree Trimmings (Yard Waste)



[www.oaklandparkfl.gov](http://www.oaklandparkfl.gov)

954-630-4452



## Recycling Service Area Map

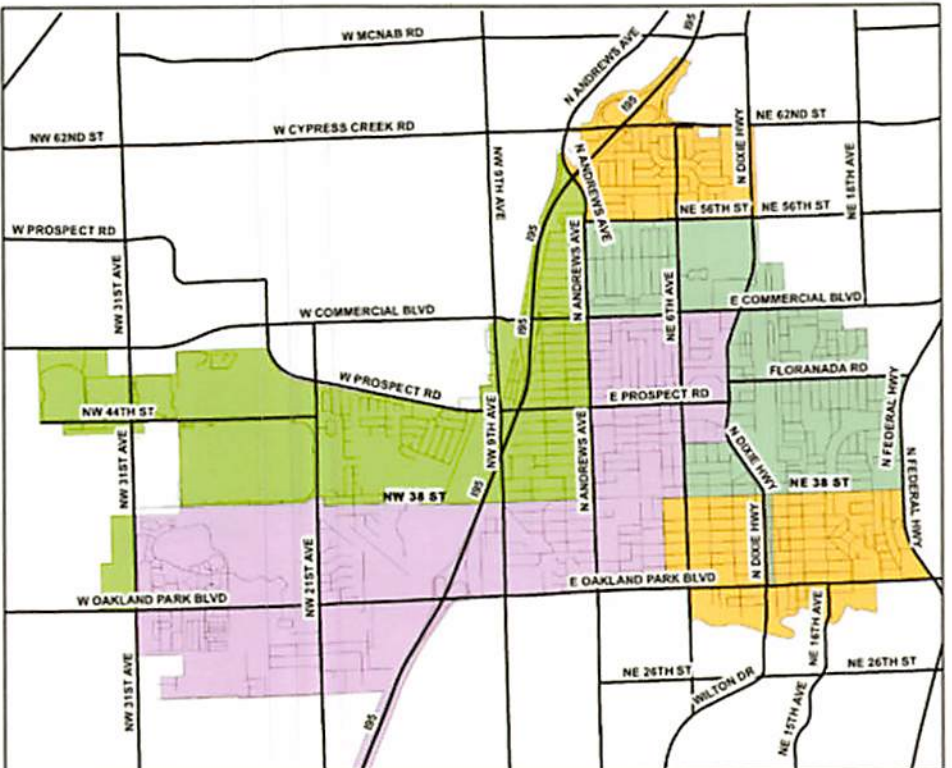

City of Oakland Park - Recycling Collection Days



### New Recycling Collection Schedule

#### Collection Days

- Monday
- Tuesday
- Thursday
- Friday

[www.oaklandparkfl.gov](http://www.oaklandparkfl.gov)





## Electronics Recycling Program



The Achievement & Rehabilitation Centers (ARC) accepts electronic items for recycling. The ARC Broward at 3300 SW 13th Ave., Ft. Lauderdale, 33315 - Open Monday - Friday from 8:30 am to 4:00 pm. Tel: 954-577-4160 and The ARC Broward at 10250 NW 53rd Street, Sunrise, 33351. Open Monday - Friday from 8:00 am to 4:00 pm. Tel: 954-746-9400 accepts electronics. For additional information, call the Oakland Park Solid Waste Office at 954-630-4452.

### Acceptable Items



- Televisions
- Computers & components (laptops, keyboards, monitors, external hard drives, modems, printers, computer mouse, terminals)
- DVD or VCR players
- Fax machines and copiers
- Telephones (cellular or other plus chargers)
- Rechargeable batteries

### Unacceptable Items

- Audio equipment (stereos and speakers)
- Small appliances
- Microwave ovens
- Alkaline batteries
- Meters
- Business-generated items

.....  
 For more information call 954-630-4452 or visit Oakland Park's Website  
[www.oaklandparkfl.gov](http://www.oaklandparkfl.gov)  
 .....



## Unacceptable Bulk Trash Items That Will Not Be Collected



- Household Hazardous Waste (HHW) (See Page 8 for description and disposal information) or Bio-Hazardous/Medical waste (for disposal of Bio-Hazardous/Medical waste contact the Solid Waste Office)
- Bulk trash generated by a person other than the resident of the residential unit
- Construction material or demolition debris (concrete material, cinder blocks, bricks, or lumber) sand, dirt, rocks, sod or tree stumps
- Household garbage will not be collected with bulk trash
- Auto or marine parts (batteries, tires)
- Items left in front of vacant land or vacant homes
- Items within four feet of fences, poles, hydrants, cars, refuse carts or under low overhead wires or tree branches



*Public Works Department reserves the right to make final determination in the application of these rules.*

### Bulk Trash Special Pickup and Roll-Off Containers

When a resident has acceptable bulk trash to be picked up at other than the scheduled time or has construction or demolition material to be picked up, a special pickup can be arranged for a fee. The minimum charge is \$60.00 and the fee is based on the total cubic yards of material to be picked up. Contact **Utility and Billing Services at 954-630-4280** for a special pickup.



For information on Roll-Off Containers used during remodeling and construction, contact the **Solid Waste Office at 954-630-4452** for a listing of those companies permitted to operate this service in the City.





## Residential Garbage Collections Guidelines

**R**esidential garbage is collected twice per week in accordance with the schedule on Page 12. Residents who have their garbage collected by City staff are provided 96-gallon carts for their use. Scheduled collection days remain in effect for all holidays other than Christmas (service is omitted on Christmas and not rescheduled).



### Carts Collection DO'S

- Place garbage carts and cans curbside in the proper location in the front of your house by 7 a.m. on designated collection days.
- All regular household refuse and garbage must be in carts.
- All garbage and grass clippings must be in bags.
- Yard trimmings must be two feet or less in length and less than four inches in diameter to fit inside the cart.



### Cart Collection DON'TS

- Carts should not be within three feet of any item (cars, fences, hydrants, etc.) at curbside.
- Carts should not be overfilled or have material protruding above the lid opening.
- Do not place items on top of the carts.
- Do not place construction debris, concrete, sand, dirt, rocks, sod or hot coals inside carts.
- Do not place Hazardous Waste or Bio-Hazardous/Medical Waste in carts (paints, paint thinners and strippers, used oil, automotive fluids and gasoline, solvents, pesticides, fertilizers, pool chemicals, spot removers, oven and drain cleaners, metal polish, tires, rechargeable or automotive batteries or medical waste.)

## Household Hazardous Waste Program



**O**akland Park offers a FREE drop-off program for household hazardous waste for all City residents. The City does not collect hazardous waste material. These are materials which, if not handled and disposed of correctly, can present a hazard to humans and the environment. Beginning on Saturday, January 4th, 2014, and every Saturday thereafter, Oakland Park residents will be able to dispose of household hazardous waste (HHW) and electronic waste at the SUN 2 facility located at 2281 NW 16th Street, Pompano Beach 33069 on Saturdays from 8 a.m. to 4 p.m. Proof of City residency is required. For personal identification and other requirements go to Page 7. For additional information, call the **Oakland Park Solid Waste Office at 954-630-4452** or visit the City's website: [www.oaklandparkfl.gov](http://www.oaklandparkfl.gov). Residents unable to use this facility or having hazardous waste materials not accepted by this facility should call **Oakland Park Solid Waste Office at 954-630-4452**.

### Acceptable Items



- Paints (oil and latex)
- Paint thinners and strippers
- Used oil and oil filters
- Automotive fluids, gasoline and solvents
- Pesticides

- Insecticides
- Fertilizers
- Pool Chemicals
- Fluorescent light bulbs
- Spot removers
- Oven and drain cleaners
- Furniture and metal polishes
- Mercury, rechargeable, and auto batteries
- Propane Tanks
- Fire extinguishers and flares



### Unacceptable Items



- Bio-hazardous/medical waste
- Explosives
- Business-generated material





## DROP-OFF SITES FOR BULK TRASH/YARD WASTE

**S**un-Bergeron maintains a bulk-trash/yard waste drop-off site at their SUN 7 facility located at 1815 South Powerline Road, Deerfield Beach, 33442 and at their SUN 12 facility located at 2380 College Avenue, Davie, 33317. Drop-off is free for Oakland Park residents at both of these facilities. Bulk-trash/yard waste is accepted only on Saturdays from 8 a.m. to 4 p.m. Oakland Park residents can use these facilities up to four times a month.

Proof of residency (including a driver's license and tax bill or TRIM notice indicating the solid waste assessment, a Courtesy Notice of Violation, or Notice of Violation letter) is required.

The center accepts bulk waste including furniture, appliances, and yard waste. The following items are **not accepted**: garbage, electronics, explosives, radioactive materials, sewage, and dead animals.

**Large loads:** If you have an exceptionally large amount of bulk waste to dispose of, please contact the **Solid Waste Office** at 954-630-4452 weekdays from 8 am to 5 pm prior to arrival.

### Vehicles prohibited at the stations:

- Commercial vehicles
- Truck with beds longer than eight feet
- Trucks with beds wider than six feet
- Trucks larger than full size (one ton pickup)
- All modified truck beds
- Trailers longer than eight feet
- Rental vehicles exceeding one ton capacity



## Commercial/Multi-Family

### Garbage Collection Guidelines

**F**or Solid Waste administration purposes, multi-family structures with more than three residential units are classified as commercial and are subject to all commercial requirements. Solid Waste staff will review each application to determine the type and frequency of service needed: cart (twice per week in accordance with the schedule on Page 12) or dumpster (one to five weekdays per week). Scheduled collection days remain in effect for all holidays other than Christmas (service is omitted on Christmas and not rescheduled).

### Commercial/Multi-Family Cart Service

 Commercial / Multi-family cart service requirements and schedules are the same as those for residential service. (See Page 3.)

### Commercial/Multi-Family Dumpster Service

 The City provides commercial dumpster service to all multi-family units and businesses. Additionally, dumpster customers, who are charged for solid waste collection on the basis of the cubic yardage of solid waste collected, can save collection expense by putting recyclable material in recycling carts rather than in dumpsters. Dumpster service is based on cubic yardage. The City provides dumpsters from 2 cubic yards to 8 cubic yards. All dumpsters must be screened from the public view. Damage to the dumpster other than normal wear and tear is the customer's responsibility.

### Dumpster Collection DON'Ts

- No Hazardous Waste of Any Kind
- No Whole Furniture (Mattresses, Couches, Tables, Chairs, etc.)
- No Propane Gas Tanks, Fire Extinguishers, Acetylene Gas Tanks, Oxygen Tanks
- No White Goods (Appliances)
- No Tires or Auto Parts
- No Construction Debris (Concrete, Rocks, Dirt, Steel Re-Bar, Drywall, etc.)
- No Tree Limbs Over Four Feet in Length or Over Six Inches in Diameter
- Do Not Exceed Maximum Weight of 6,000 Pounds





## Collection Container Maintenance Information

**Y**our cart or dumpster is City property, but the resident is responsible for it. If it is stolen or vandalized, please contact the **Broward Sheriff's Office at 954-561-6161** to report the incident and obtain a "incident number". Then report the incident to the **Solid Waste Office at 954-630-4452** with the "incident number" issued by BSO. The City will repair or replace the solid waste container as appropriate. Additionally, if your container is damaged, contact Solid Waste for repair or replacement. Containers that are damaged through neglect or improper use are repaired or replaced at the customer's expense.

To keep carts clean and odor free, they should be washed regularly with detergent and water. Do not paint or alter the exterior of your cart.

When moving, the cart is to remain at the current location for the next resident's use.

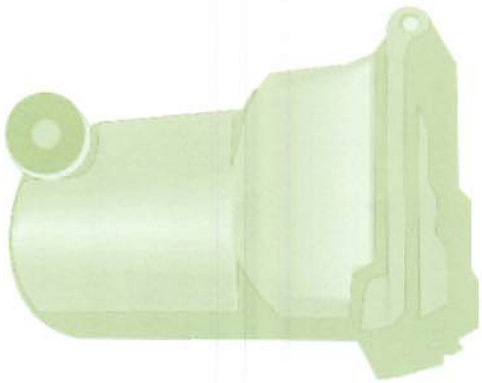

## Single Stream Recycling Services 65 gallon carts provided

**W**eekly curbside recycling service is provided for all solid waste customers. See Page 10 for collection days for each area. Participation in the program reduces consumption of our resources and improves the environment. Each residential unit paying the annual assessment for solid waste removal receives one (1) blue 65 gallon roll cart to place all of your recyclables in for collection. To participate in our recycling program, contact our **Utility and Billing Services Office at 954-630-4280** to request your recycling carts. Additionally, the City maintains recycling containers at the **Municipal Service Complex, 3801 NE 5th Avenue**, for drop-off recycling.



## YES RECYCLING ONLY Deposit Only These Clean Items:

- Clean paper, Milk Cartons, Cardboard (limit 18 x 24), Junk Mail, Paper Egg Cartons, Cereal Boxes
- Newspapers, Magazines, Catalogs, Phone Books
- Plastic Bottles and Jugs (no caps), Plastic Dairy Tubs (yogurt, margarine, etc.) no lids
- Aluminum Cans, Steel or Tin Cans
- Loose Glass Bottles and Jugs

**U**sed Tires: Residents can drop off, free of charge, up to four tires each visit to our tire drop-off center located at the **Municipal Services Compound, 3801 NE 5th Avenue**. To be accepted, tires must be removed from the rims. For instructions or questions, please visit the **Solid Waste Office** or call **954-630-4452**. Monday through Friday - 8 am - 4:30 pm.



*\* Two forms of ID are required to participate in this program:  
1. A driver's license or photo identification with current address  
2. A utility bill such as electric, water, cable, telephone or a tax notice that matches the address on the driver's license.  
Any users without the required proof of residency will be denied access.*

### Recycle Right

**E**veryone can play a part in recycling... and your part is to "Recycle Right." If items are not recycled correctly, they cannot be used again. Placing unacceptable items in recycling bins can ruin an entire load, resulting in the load being sent to the landfill. To ensure your efforts and good intentions are productive, please remember to "Recycle Right." CONTAINERS USED FOR BLEACH, OIL, GREASE, HAZARDOUS MATERIAL, HOUSEHOLD CLEANERS, MEDICAL WASTE, MICROWAVE CONTAINERS, PLASTIC BAGS OR STYROFOAM CONTAINERS SHOULD NOT BE PLACED IN THE 65 GALLON RECYCLING CART.

